

\* Tables & Chairs must be cleaned off and returned to storage after use.  
 72-inch round tables, 12 per hall  
 White banquet chairs, 120 per hall



Place filled garbage bags in bins located by shed. Extra garbage bags can be found in the kitchen, on the shelving unit next to the refrigerator. Container is marked garbage bags



- A. Sink
- B. Prep counter and service windows
- C. Grill and griddle
- D. Large two-door refrigerator
- E. Freezer
- F. Janitor sink / mop & bucket / broom

Tables & Chairs storage\*

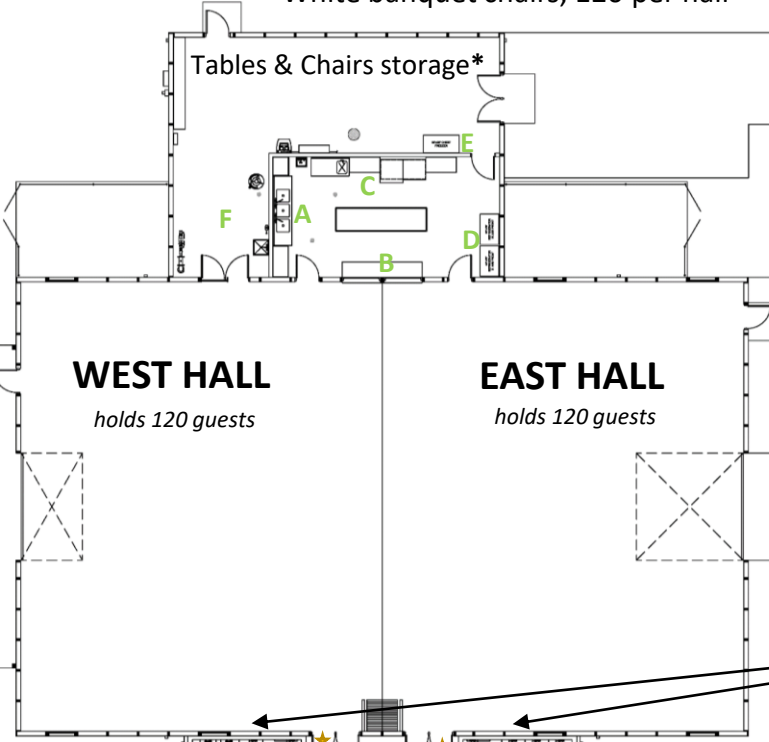

**WEST HALL**  
*holds 120 guests*

**EAST HALL**  
*holds 120 guests*

**Covered Patio**

Electronic doors: ★  
 Interior Hall doors will unlock at set times.  
 Exterior doors open during park hours

- Located on wall by entrances (both halls)
- Cleaning checklist
  - AED
  - Hexagon key to unlock additional doors.
  - Temperature controls (controlled by City Staff)



# Broske Center Rental Details

*Not Included in rental: table linens and cleaning supplies*